



RENEW[™] traction

TRACTION ELEVATOR MODERNIZATION

VantageElevation.com / renewtraction@vantageelevation.com

MODERNIZATION MADE EASY



REQUEST



QUOTE



ORDER

Introducing our **RENEW™** traction modernization solution offering customers five key traction products in one, reducing complexity and loss of valuable time.

VANTAGE *RENEW*[™] traction BENEFITS:



- Pricing includes initial drop ship cost
- Includes our industry leading, non-proprietary key system components – controller, hoist machine, door equipment, fixtures, and roping package
- Reduces labor resources, saving you time and money
- Save time using *RENEW*[™] traction
1 Request | 1 Quote | 1 Order
- Increased reliability, ride quality and value
- Unmatched product and customer support

GENERAL SCOPE

- Simplex or Group (4 cars max.)
- Class of Loading: A
- Speed: up to 500 fpm
- Capacity: 1000 – 5000 lbs.
- Maximum Stops: 20
- Maximum Openings: 40
- Travel: 285' – 0"
- Environment: NEMA 1 Machineroom and hoistway conditions
- Hoist machine type: Geared or AC Gearless
- Drive type: Non-Regenerative and Regenerative

RENEW™traction

RENEW™traction CORE PRODUCTS

Choice of geared or gearless machine, choice of Pixel or Galaxy non-regenerative or regenerative controller, GAL-MOVFR or MOVFE-HL door package, MAD fixtures or fixtures by others, hoist rope and wedge shackle package, and standard ground freight.

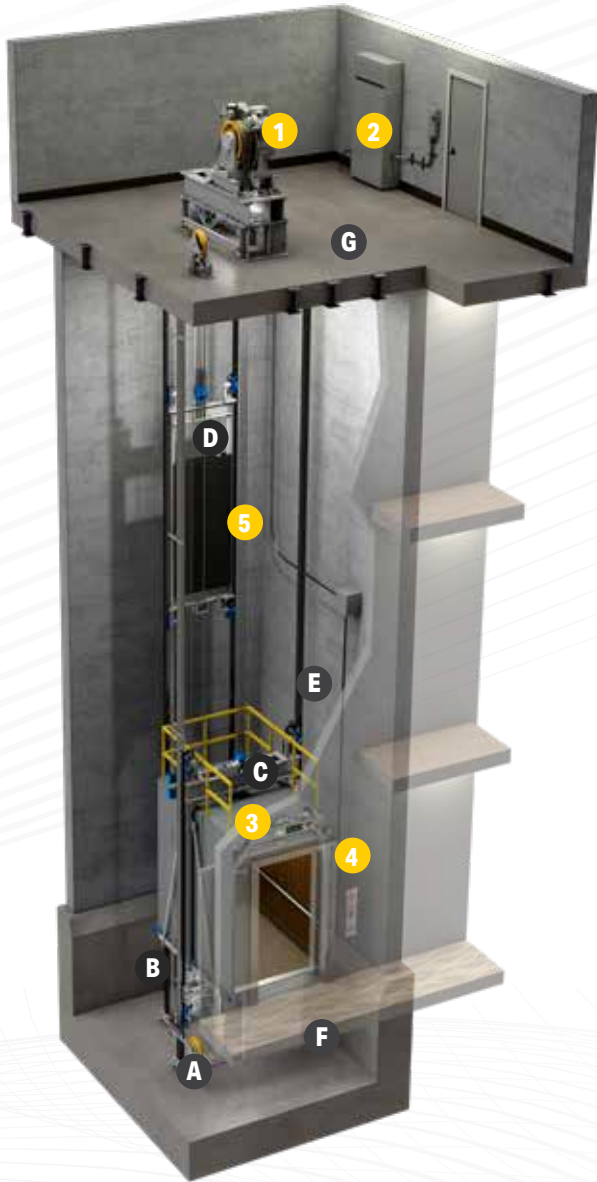

- 1 **BEAMS, ROPE RETENTION,
AND GUARD PACKAGE**
- 2 **CONTROLLER, LANDING SYSTEM**
- 3 **DOOR EQUIPMENT PACKAGE**
- 4 **FIXTURE PACKAGE**
- 5 **HOIST ROPE AND WEDGE
SHACKLE PACKAGE**

Standard ground freight included

RENEW™traction OPTIONAL PRODUCTS

- A Governor, tension weight, and governor rope package
- B Safeties
- C Sling and Platform
- D Counterweight Frame
- E Car and counterweight guides
- F Spring or hydraulic buffers
- G Machineroom layout drawing

1 CHOICE OF HOIST MACHINE



BENEFITS

- Wide range of drive sheave diameters
- Easy disassembly and reassembly
- Compact footprint

STANDARD FEATURES

- Standard NEMA C-face motor flange
- Optimized for VVVF motor drives
- Compact steel base with integral Rope Gripper® mounting
- Quiet brake solenoid
- Sealed bearings for reduced maintenance



BENEFITS

- Excellent ride quality
- Energy efficient design ideally paired with a regenerative drive
- 28 and 40 pole motor designs offer smooth, quiet, and cool operation
- Low maintenance
- Cool operation

STANDARD FEATURES

- 2 independently controlled braking system;
 - Each capable of stopping and holding 125% of rated capacity
 - Optional Rope Gripper® in lieu of machine brake(s) being established as the emergency brake
- Sub-bases available to incorporate Rope Gripper® and/or deflector sheave
- Sealed bearings for reduced maintenance

2 CHOICE OF CONTROLLER



BENEFITS

- Simple navigation using Touch & Go™ onboard user interface from 3 access points (machine room, inside cab, cartop)
- Color LCD screen is easy to learn, simple to read, and common across Pixel control types

STANDARD FEATURES

- Main controller, cartop processor, car operating processor, Landa™ absolute positioning system, CAN serial hall fixture node boards
- CAN-bus serial communication offers ease and speed of wiring and enhanced diagnostic capabilities

OPTIONAL FEATURES

- Regenerative drive
- Monitoring



BENEFITS

- Onboard user interface

STANDARD FEATURES

- Serial communications linked to smart interfaces, reducing car and hoistway wiring

OPTIONAL FEATURES

- Regenerative drive
- Monitoring

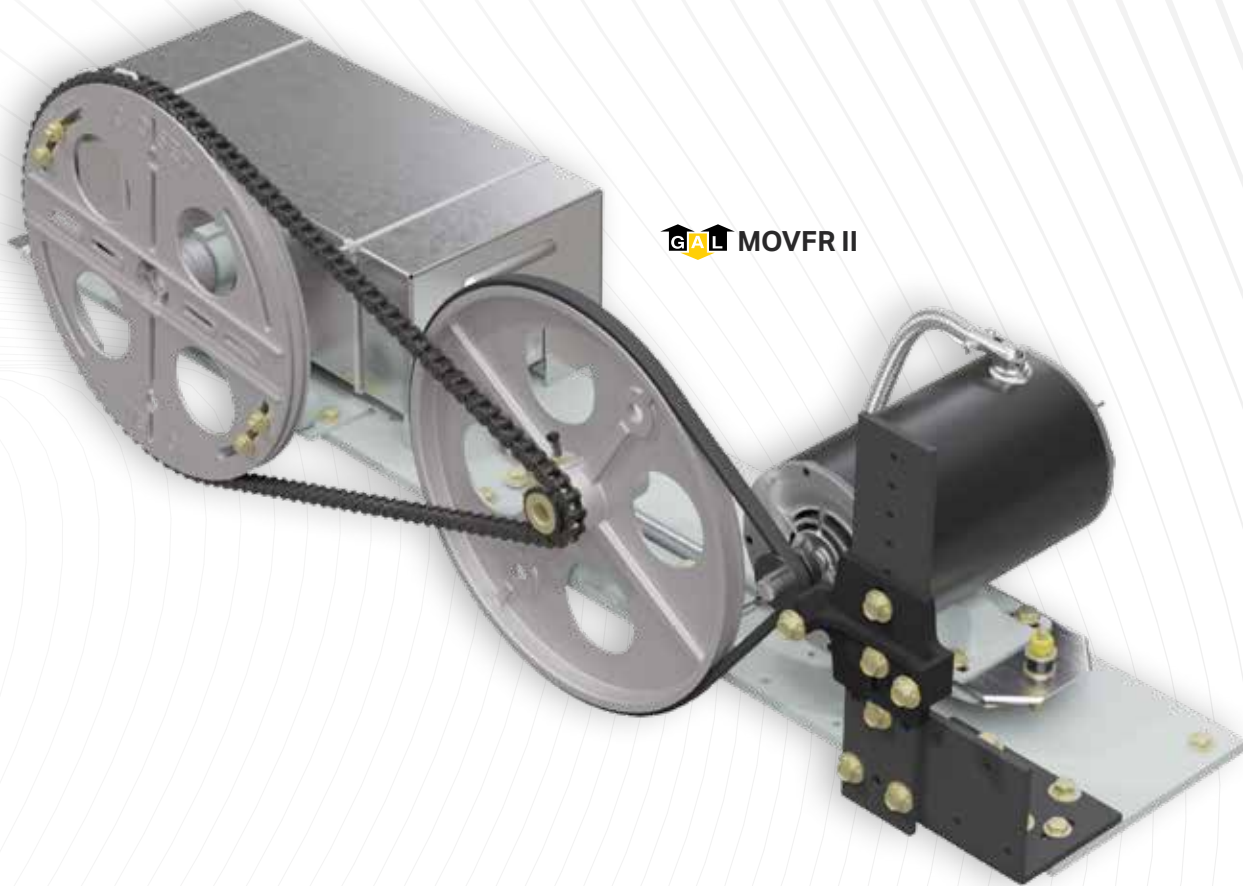

GAL MOVFR II

3 DOOR EQUIPMENT

GAL is the most trusted brand for non-proprietary door equipment with combinations to satisfy all applications.

RENEW™ traction offers you five convenient door bundles (three Harmonic and two Linear) for cabs up to 10' and door heights up to 9':

GAL-MOVFR II DOOR OPERATOR PACKAGE:

- Closed loop door operator, gate switch, arm(s), car door clutch and ScanGuard "Plug and Play" infrared door protection w/ integrated power supply
- Standard features include VVVF closed loop motor control, built-in diagnostics, up to 5 preset parameters, CAN communication connection
- NEMA 1 enclosure and a heavy duty 1/2 HP 220-230 VAC motor

GAL-MOVFR II DOOR OPERATOR AND CAR DOOR EQUIPMENT PACKAGE:

- Door operator package (listed above) + car door tracks, hangers, rollers, wiper kits and headers

GAL-MOVFR II CAR AND HATCH DOOR EQUIPMENT PACKAGE:

- Door operator package (listed above) + car door equipment package (listed above) + hatch door hangers, rollers, top safety retainer, tracks, spring door closers, interlocks, keepers, roller releases, pick up rollers, linkage and hardware



GAL MOVFE-HL CAR DOOR PACKAGE:

- Dual closed loop linear door operator, car door track, hangers, header, gate switch, car door hangers, rollers, wiper kits, car door clutch, and ScanGuard "Plug and Play" infrared door protection w/integrated power supply

GAL MOVFE-HL CAR AND HATCH DOOR EQUIPMENT PACKAGE:

- Operator / car door package (listed above) + hatch door hangers, rollers, top safety retainer, tracks, spring door closers, interlocks, keepers, roller releases, pick up rollers, linkage and hardware

OPTIONAL DOOR EQUIPMENT

- | | |
|--|---------------------------|
| • Formula systems (FCU 47) 2D substitution | • Reel door closers |
| • Tri-tronics leading edge 2D substitution | • Door unlocking key |
| • Formula vision 3-3D substitution | • Handheld parameter tool |

4 FIXTURES

RENEW™traction includes Vantage Fixtures Designed & Made by MAD, offered in four common finish types including Stainless Steel # 4, Stainless Steel # 8, Muntz # 4 and Muntz # 8.

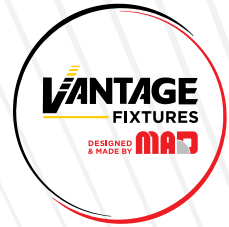

STANDARD CAR OPERATING FEATURES:

- 7.0" LCD position and direction indicator
- Durable, visually aesthetic buttons and switches
- Choice of button type
- Choice of illumination
- Applied, mini-swing and full swing
- Emergency light
- Rath emergency phone
- Service cabinet
- Local fire code compliance
- Jurisdiction specific engraving
- Auxiliary COP

OPTIONAL CAR OPERATING PANEL FEATURES:

- Certificate frame
- Attendant operation
- Door hold button
- EMT operation
- Card reader provisions
- Keyed floor lockouts
- Hospital service (code blue)
- Voice annunciation
- Cab lighting dimmer
- Reset switch
- "Pull to stop" emergency stop button
- Phone jack
- Engraved no smoking symbol
- Mosaicone cloud based two way audio | video | messaging | monitoring
- Spare key switches



STANDARD HALL STATION FEATURES:

- Flush mount w/box
- Jurisdiction specific engraving
- Local fire code compliance

OPTIONAL HALL STATION FEATURES:

- Surface mounting
- 2.8" LCD position indicator
- Car-to-lobby operation
- Hospital service (code blue)
- EMT operation
- Keyed floor lockouts
- Emergency power

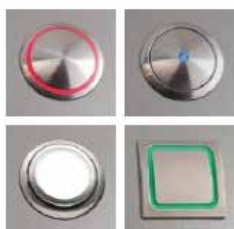

CHOICE OF BUTTON OPTIONS

- Whether you are looking for basic, vandal resistant, California compliant or a premium look, we have a high-quality button selection for you!

4 SIGNAL FIXTURES



HALL FIXTURES

- Hall lanterns – Standard or vandal resistant flush or surface mounting
- Hall position indicators – 4.3" Flush of surface
- Combination hall lantern / 4.3" LCD position indicators
- Standard or vandal resistant
- Flush or surface mounted

5 ROPE PACKAGE

- Hoist ropes individually spooled, and batch matched
- Staggered length wedge shackles including, double nut, cotter pin and 2 clips
- Optional isolation spring isolation kits



OPTIONAL **RENEW™**traction PRODUCTS

A GOVERNOR, TENSION SHEAVE, GOVERNOR ROPE PACKAGE



- LH or RH
- 12" or 16" sheave diameters
- 3/8" or 1/2" rope diameter
- Swing arm or frame tension weights
- 8x19, RRL, Traction Steel Rope

B TYPE A OR TYPE B SAFETIES

- Adjustable stopping force
- Easy access for inspection
- Self-resetting safety plank switch



C SLING AND PLATFORM

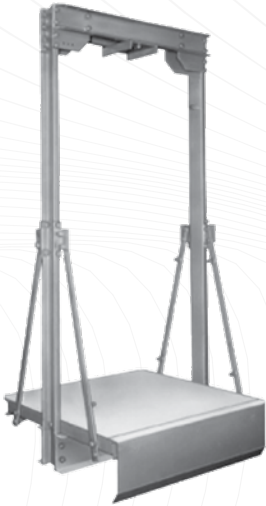

- Structural steel construction benefiting to ride quality
- Isolated platform
- 26 gauge under platform fireproofing
- 2 layers of marine grade plywood
- Seismic and non-seismic provisions

D COUNTERWEIGHT FRAME

- Structural steel construction
- Dual through rod counterweight filler retention
- Filler weights (optional)
- Filler weight drawing if provided by others



E GUIDES



- Precision machined
- High-quality heavy-duty rollers
- Advanced bonding technology
- Post wise and fore and aft adjustments
- Mounting alignment / adjustment

F BUFFERS



- Hydraulic and spring buffers
- Spring return (hydraulic)
- Buffer switch (hydraulic)

G MACHINE ROOM LAYOUT

Coordinate installation of:

- New controller, machine, and governor
- Machine beam point load reactions
- NEC compliant step back clearance

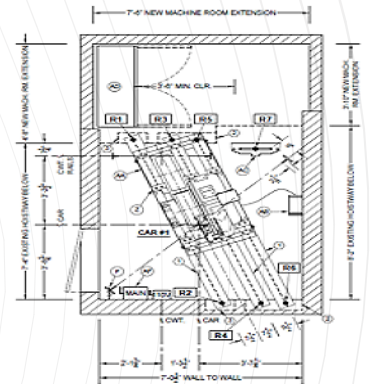

G QUICKCAB® CAB INTERIOR UPGRADE

- Choice of 1 of 26 standard cab interior designs
- Time efficient patented installation system provides a professional new look in a fraction of the time
- Match other architectural building interior finishes
- Modular design allows for quick and easy repairs
- Durable lightweight materials help ensure removal / replacement weight compliance



Utilize our helpful QuickCab® interior design rendering tool for proposals located at: www.quickcabs.com Click on the Design tab and create multiple 3D views and a PDF design specification and rendering!

QUOTE REQUEST

Submit quote requests to:
renewtraction@vantageelevation.com



Download our Product Definition, Request For Quote (RFQ), and Field Survey Forms or contact your local region representative for more information.

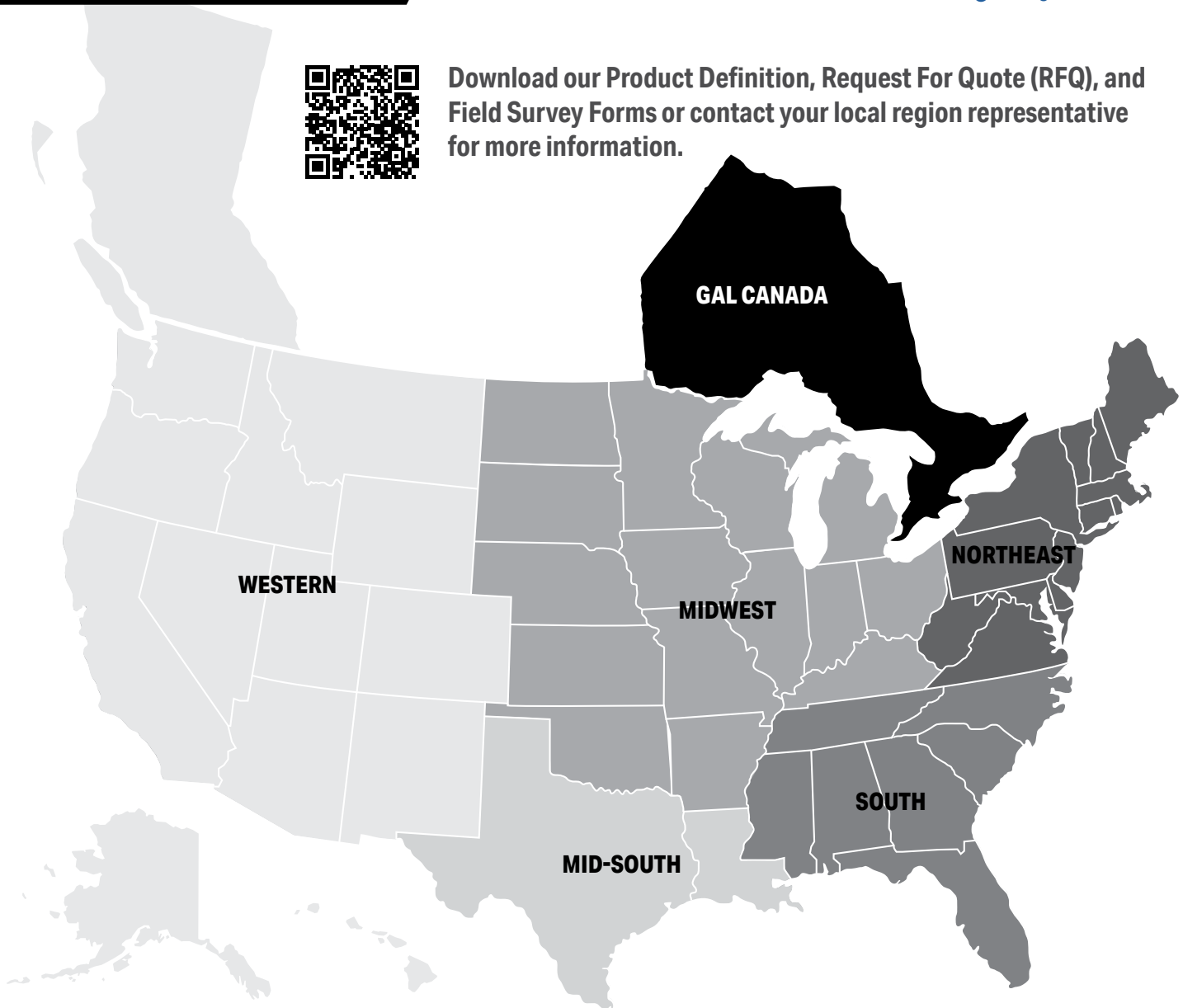

MAP KEY



NORTHEAST - JOE MOLONEY
joseph.moloney@vantageelevation.com
(631) 456-9392



SOUTH - MATT SLAATS
matt.slaats@vantageelevation.com
(770) 402-1336



MIDWEST - FREDDY FLORES
freddy.flores@vantageelevation.com
(347) 978-3589



MID-SOUTH - STEVEN TRAN
steven.tran@vantageelevation.com
(347) 749-6543

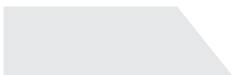

WESTERN - MARK ORTIZ
mark.ortiz@vantageelevation.com
(562) 445-1709



GAL CANADA - GAETANO SOLDANO
info@galcanada.com
(416) 747-7967