

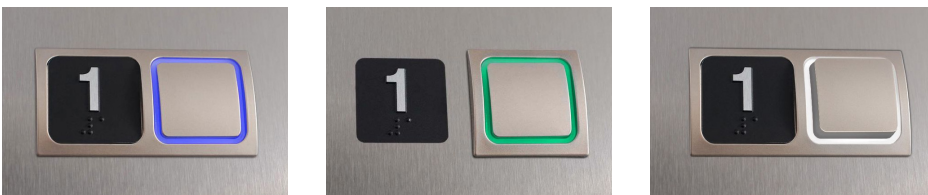

The Dune Series pushbutton is vandal-proof, cast alloy with illuminated halo. Can be paired with a standard or illuminated square braille tag.

- ✓ Studless Mounting
- ✓ Satin Nickel or Brass colored non-tarnishing finish
- ✓ LED Illumination available in Red, Green, Blue, White & Amber
- ✓ Cast or White LED illumination braille halo
- ✓ California compliant button available



SS#4 COP shown with 4.3" Mosaic TFT PI, Dune pushbutton, non-illuminated tactile.

Available Options

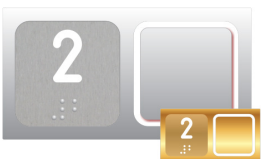

White LED - Illuminated
SS Braille Tag - 2.9x1.6"

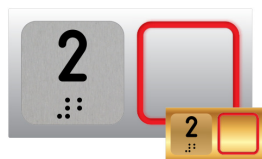

SS Braille Tag (Non-illuminated) - 2.9x1.6"

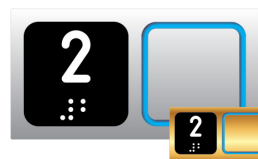

Cast Braille Tag
2.9x1.6"



No Braille Tag
1.6x1.6"

General Details

- General:** Vandal-proof Studless Frontal Mounting Cast Alloy Pushbutton. Fastened by jam-nut on plates from 11 to 22 Guage thick.
- Pressel:** Cast Zama Alloy with Satin Nickel or Brass colored finishes. Pressel activation is limited by the cast alloy base preventing any stress on the contact block resulting in an extremely robust vandal-proof pushbutton.
- Contacts:** Available with one or two microswitch(es) (2NO/1NC)
- Wiring:** Screw terminals or JST Pin Connector
- Voltage:** 24V AC/DC
- Illumination:** LED Illumination of halo in Red, Green, Blue, White and Amber.
- Stroke:** 0.060"
- Avg. Life:** 1,500,000 activations
- Degree of protection:** IPX3

Physical Characteristics

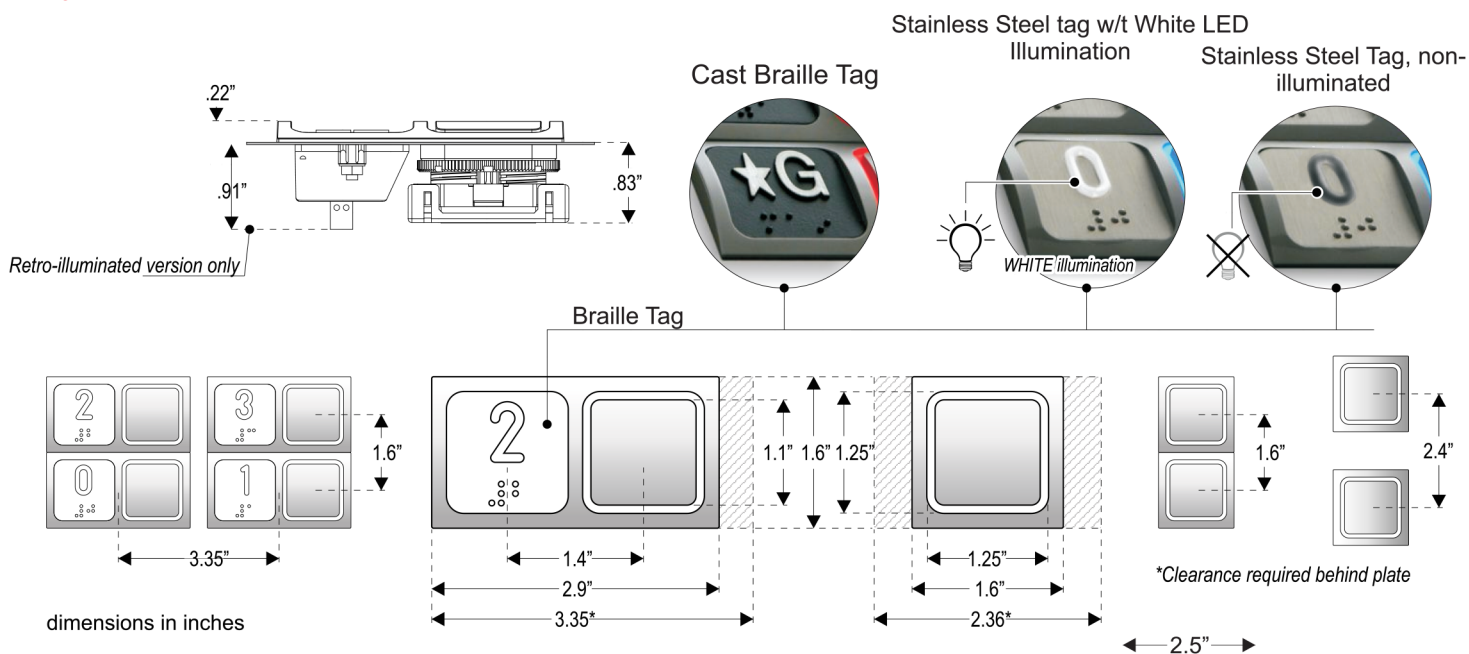

Component Ordering Information

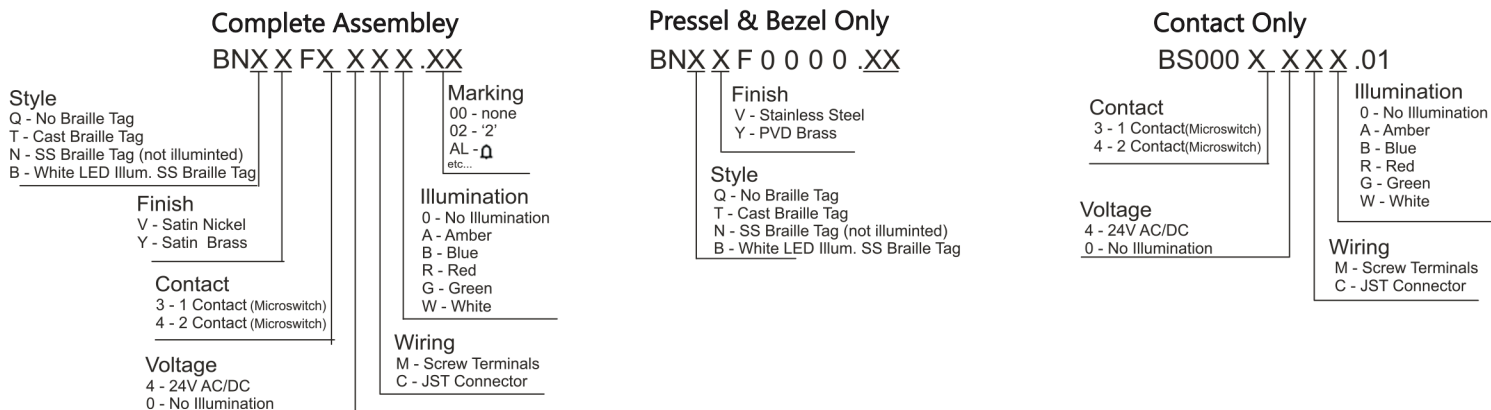

This publication is for general informational purposes only. Product design is subject to change without notice. Actual product colors and finishes may vary.

Copyright © 2020 MAD Elevator Inc.

vantageelevation.com
 (347) 226-4558
 sales@vantageelevation.com